



**LIGHT^{MY}
BRICKS**



LEGO T.REX BREAKOUT #76956

LIGHT KIT

INSTALLATION GUIDE

Light My Bricks



LEGO T.REX BREAKOUT 76956 INSTALLATION GUIDE

Hi There!

We're here to help you get started on the LEGO T.Rex Breakout 76956 Light Kit.

This PDF details the instructions for the LED light kit only.

If you run into any issues, please refer to the troubleshoot-ing section towards the end of this guide.

Have fun and enjoy!

INSTALLATION GUIDE



PACKAGE CONTENTS:



- 2 x Rotating 30cm Bit Light
- 2 x Flashing White 30cm Bit Light
- 1 x White 30cm Bit Light
- 1 x Cool White 15cm Bit Light
- 1 x Cool White 30cm Large Bit Light
- 4 x White 15cm Bit Light
- 4 x Red 30cm Bit Light
- 3 x Warm White 30cm Micro Bit Light *



- 2 x 6-Port Expansion Board
- 1 x 8-Port Expansion Board
- 1 x 4-Port Micro Expansion Board
- 1 x Spooky Effects Board
- 1 x Flicker Effects Board



- 3 x 5cm Connecting Cable
- 1 x 30cm Connecting Cable
- 1 x 50cm Connecting Cable



- 1x USB Power Cable
(Power Source not Included)

ASSORTED BRICKS:



- 3 x Plate 1x2 - Light Grey
- 1 x Plate 2x2 - Dark Grey
- 1 x Bracket 1x1 - Light Grey
- 3 x Round Plate 1x1 Open Stud - Black
- 2 x Plate 1x1 Mod Rounded w Handle - Black
- 2 x Round Plate 1x1 - Trans Light Blue
- 2 x Round Tile 1x1 - Trans Red
- 2 x Round Brick 1x1 - Trans Red
- 2 x Tile 1x1 W Clip Round Edges - Black
- 1 x Plate 2x2 W Rounded Bottom - Trans Clear

* Indicates components which include spares

Contents

Before You Begin	5
Blueprint	8
Instructions	10
Final Product	36
Troubleshooting	37
Contact	42

Before You Begin

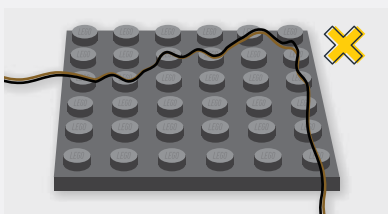
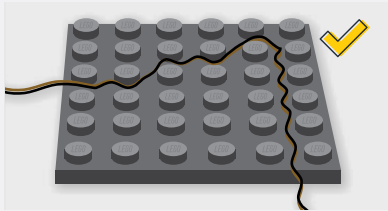

Laying cables in between and underneath bricks

Cables can fit in between and underneath LEGO® bricks, plates, and tiles providing they are laid correctly between the LEGO® studs. Do NOT forcefully join LEGO® together around cables; instead ensure they are laying comfortably in between each stud.

CAUTION: Forcing LEGO® to connect over a cable can result in damaging the cable and light.

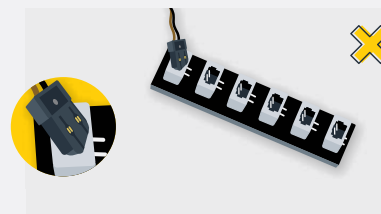
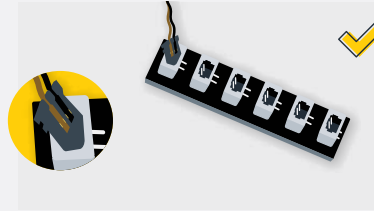

Connecting Cable Connectors To Expansion Boards

Take extra care when inserting connectors to ports of Expansion Boards. Connectors can be inserted only one way. With the expansion board facing up, look for the soldered “=” symbol on the left side of the port. The connector side with the wires exposed should be facing toward the soldered “=” symbol as you insert into the port. If a plug won’t fit easily into a port connector, do not force it.

Incorrectly inserting the connector can result in bent pins inside the port or possible overheating of the expansion board when connected.

Before You Begin

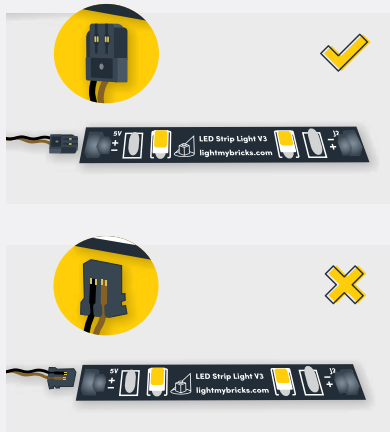

Connecting Cable Connectors To Strip Lights

Take extra care when inserting connectors to ports on the Strip Lights. Connectors can be inserted only one way. With the Strip Light facing up, ensure the side of the connector with the wires exposed is facing down. If a plug won't fit easily into a port connector, don't force it. Doing so will damage the plug and the connector.

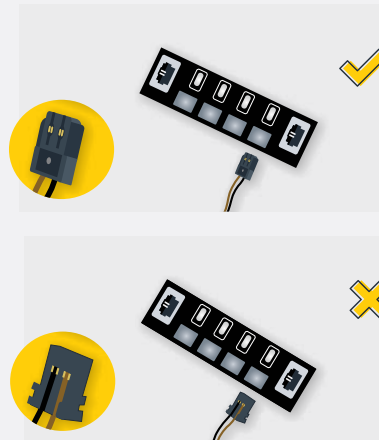

Connecting Micro Cable Connectors To Micro Expansion Board Ports

Take extra care when inserting the micro connectors to micro ports of Micro Expansion Boards. Connecting Micro Bit Lights to Micro Expansion Boards is similar to connecting lights and cables to Strip Lights. With the expansion board facing up, ensure the side of the connector with the wires exposed is facing down. If a plug won't fit easily into a port connector, do not force it. Use your fingernail to push the plastic part of the connector to the micro port.

Before You Begin

Installing Bit Lights Under Lego® Bricks And Plates

When installing Bit Lights under LEGO® pieces, ensure they are placed the correct way up (Yellow LED component exposed). You can either place them directly on top of LEGO® studs or in between.

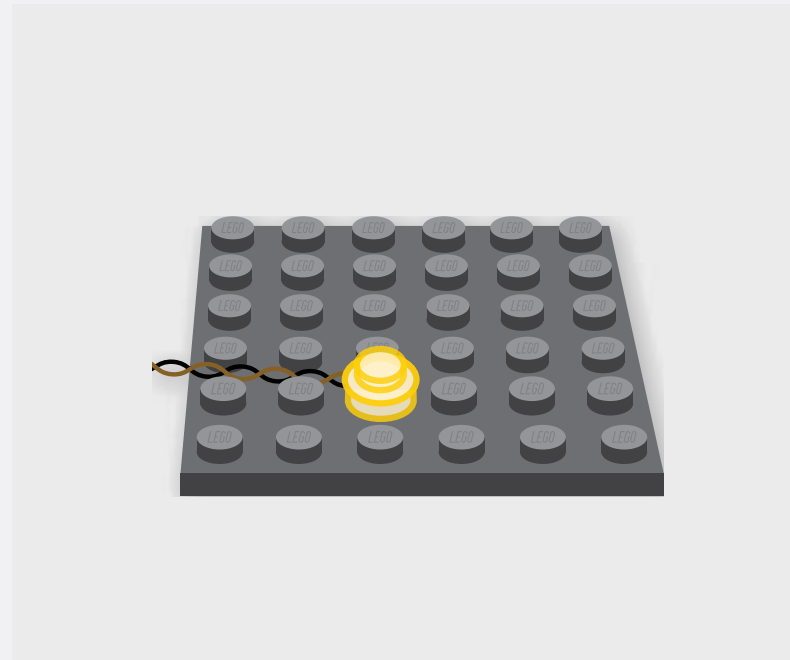

BLUEPRINT

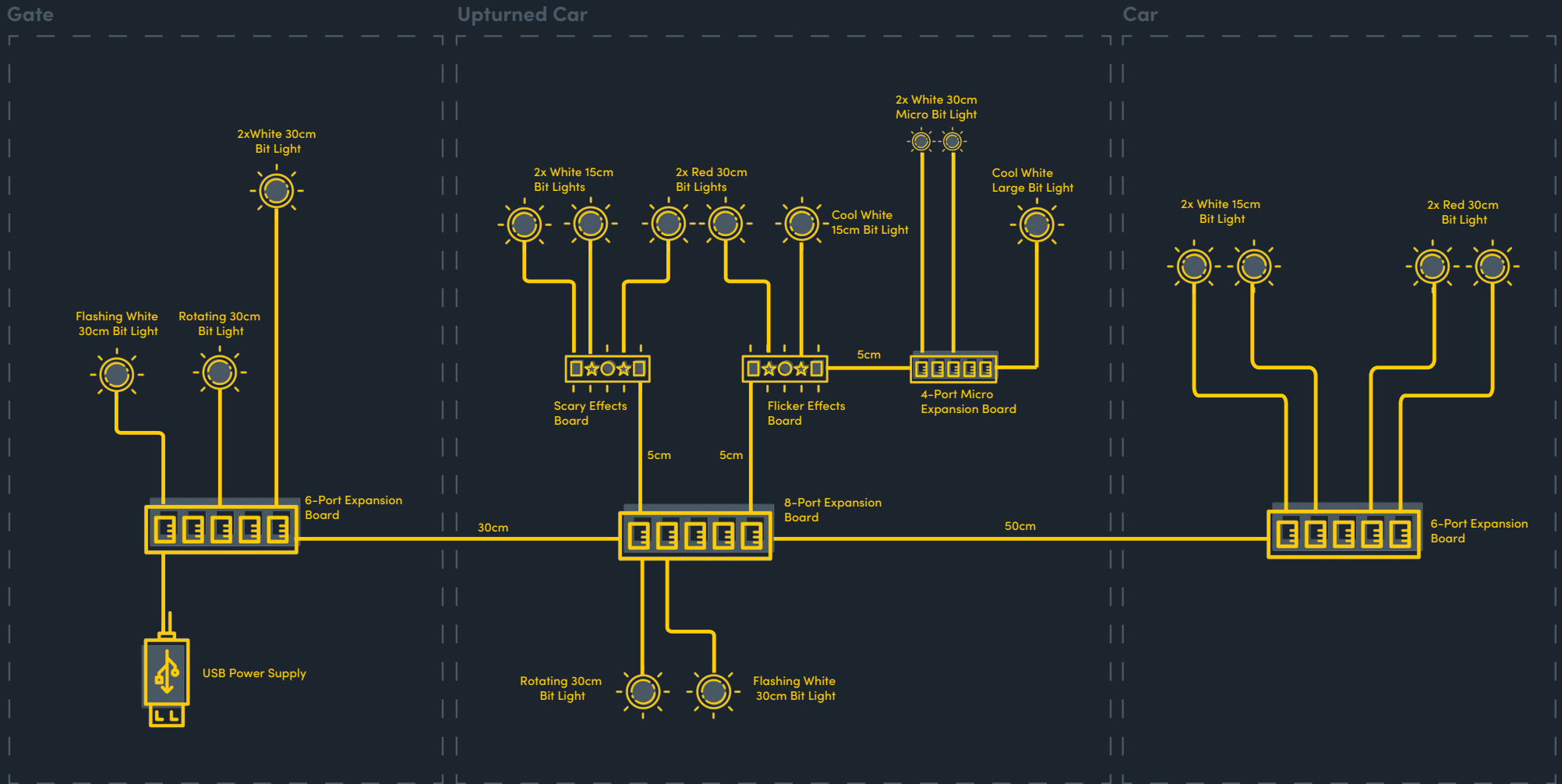



INSTRUCTIONS

To ensure a smooth installation of your light kit, please read and follow each step carefully. If you run into any issues, please refer to the online troubleshooting guide.

	LEGEND:		DISCONNECT		CONNECT / RECONNECT		TURN / FLIP		DIRECTIONAL		TWIST / BRAID		POWER ON / TEST
	LEGENDE:		TRENNEN		VERNINDEN / WIEDERVERBINDEN		WENDEN / KIPPEN		DIRECTIONAL		DREHEN / VERDREHEN		EINSCHALTEN / TESTEN
	LÉGENDE:		DÉCONNECTER		CONNECTER / RECONNECTER		TOUR / INCLINAISON		DIRECTIONNEL		TORSION / TRESSER		POWER ON / TEST
	LEGGENDA:		SCOLLEGARE		CONNETTI / RICONNETTI		ROTARE / INCLINARE		DIREZIONALE		TWIST / TRECCIA		POWER ON / TEST

1



2



Legend → DISCONNECT → CONNECT / RECONNECT ↻ TURN / FLIP → DIRECTIONAL ↻ TWIST / BRAID ✨ POWER ON TEST 📝 NOTE ICON



3

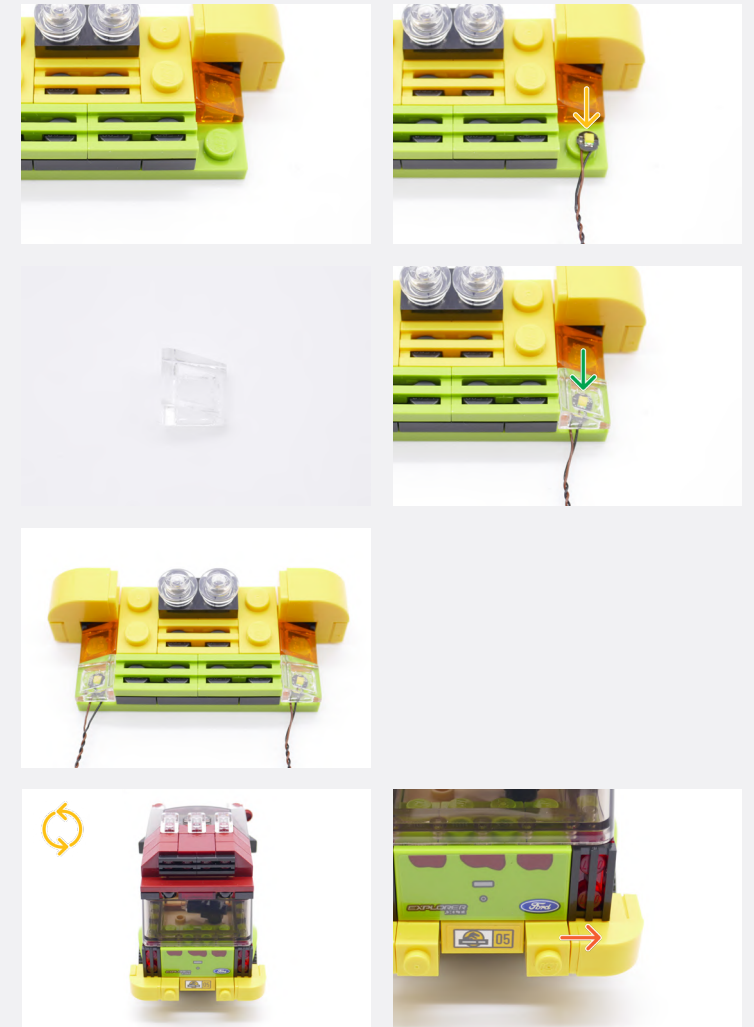

Legend → DISCONNECT → CONNECT / RECONNECT ↻ TURN / FLIP → DIRECTIONAL ↻ TWIST / BRAID ✨ POWER ON TEST 📝 NOTE ICON

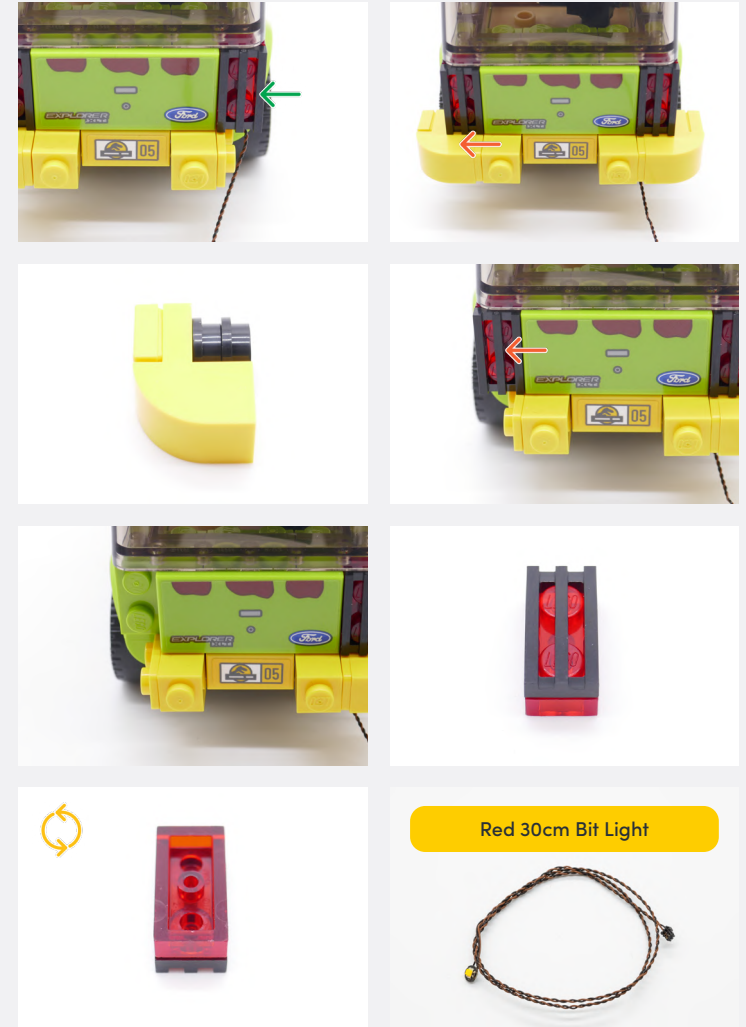
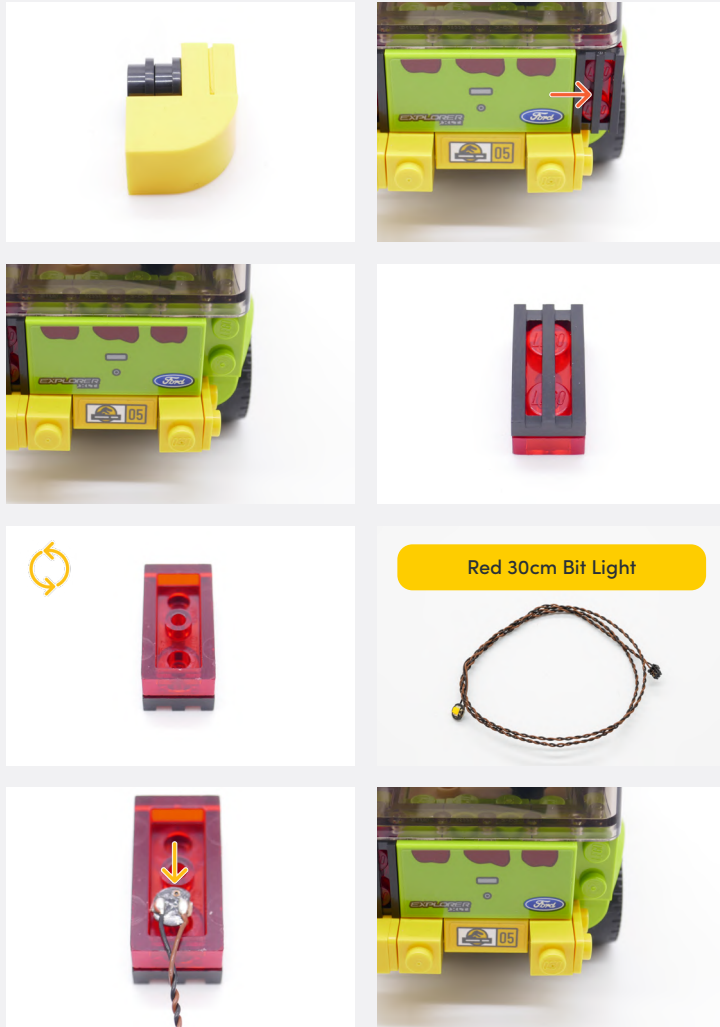

Legend

- DISCONNECT
- CONNECT / RECONNECT
- ↻ TURN / FLIP
- DIRECTIONAL
- ↻ TWIST / BRAID
- ✳ POWER ON TEST
- 📝 NOTE ICON

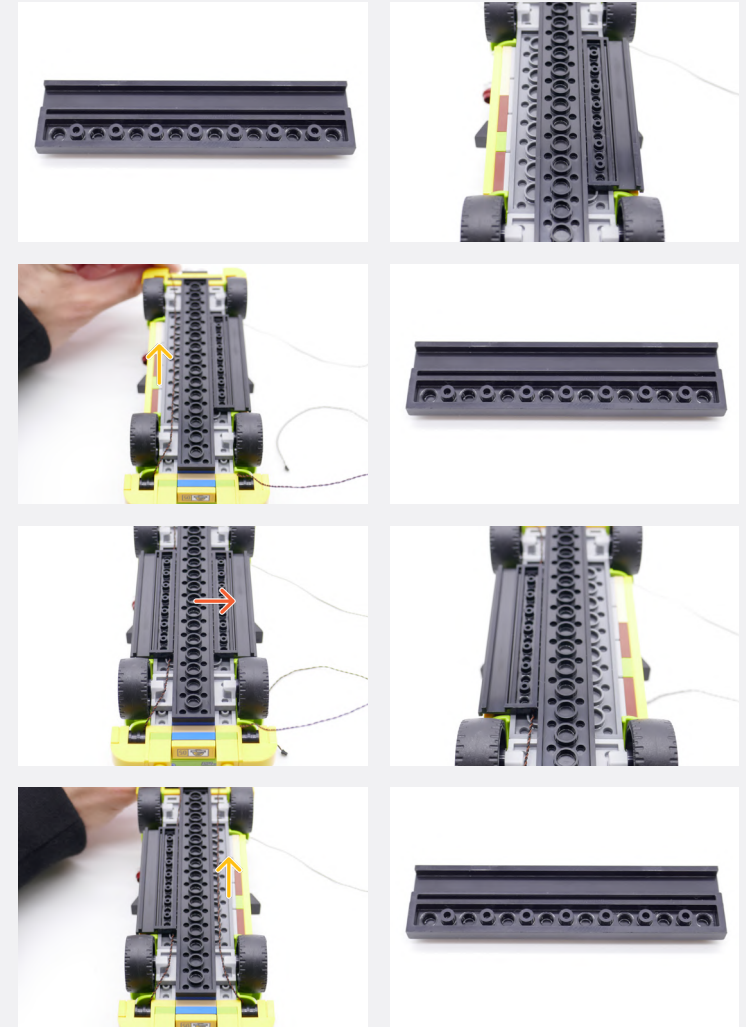

4

Legend



DISCONNECT



CONNECT / RECONNECT



TURN / FLIP



DIRECTIONAL



TWIST / BRAID



POWER ON TEST



NOTE ICON

5

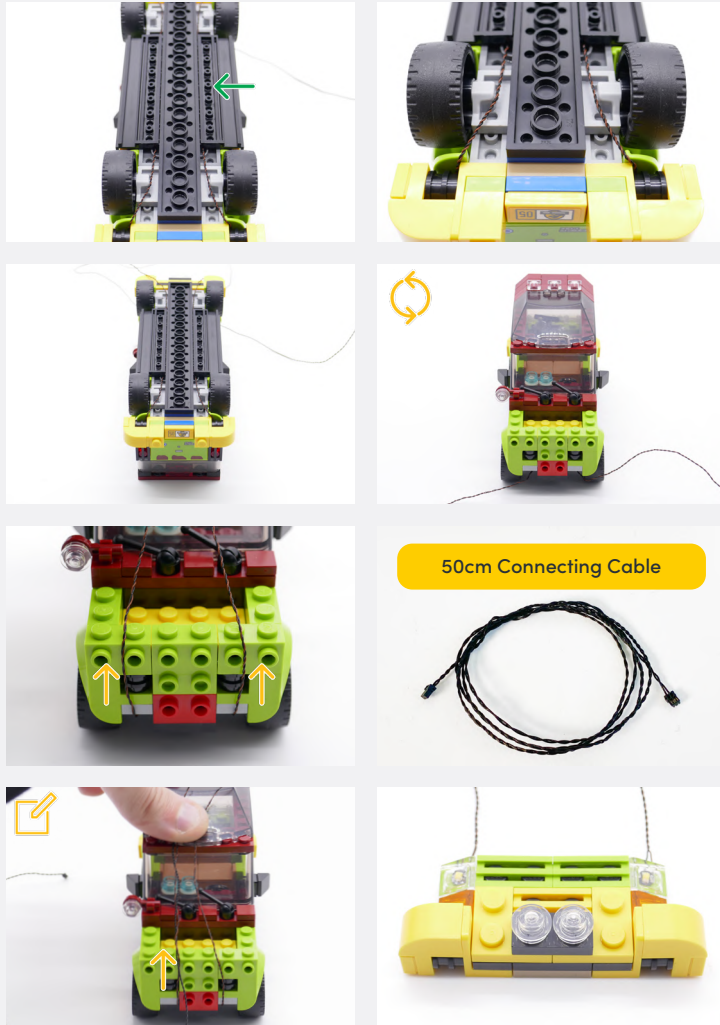

Hold the 50cm Connecting Cable in the same position as the Left Bit Light (at the same length).

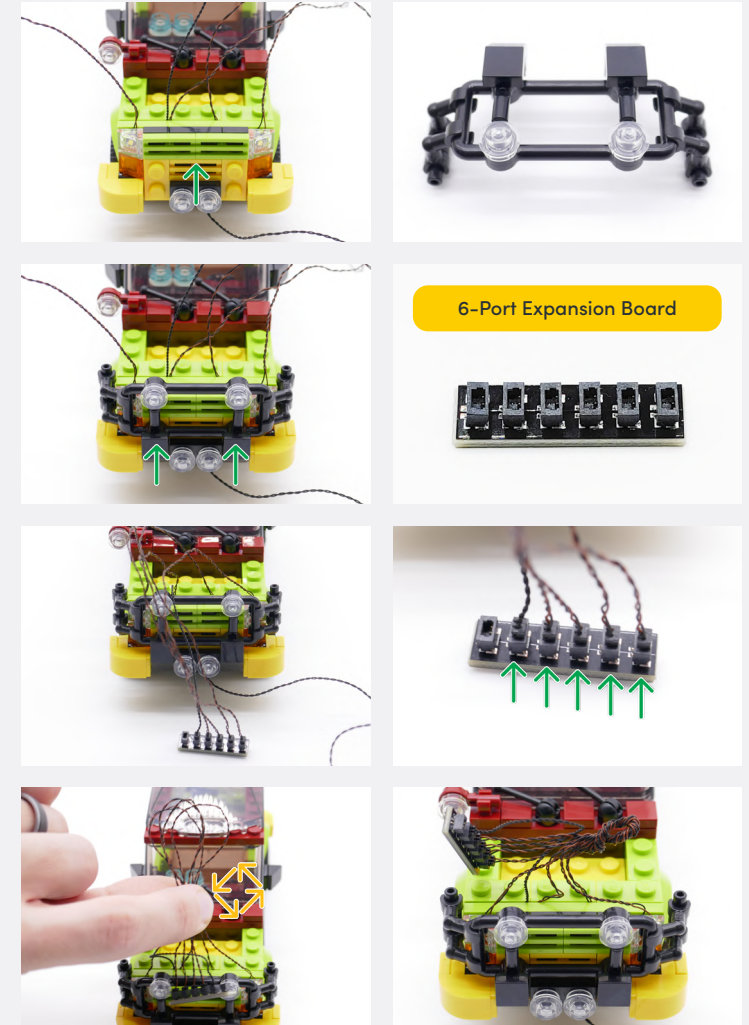

6-Port Expansion Board

50cm Connecting Cable

Legend → DISCONNECT → CONNECT / RECONNECT ↻ TURN / FLIP → DIRECTIONAL ↻ TWIST / BRAID ✨ POWER ON TEST 📝 NOTE ICON

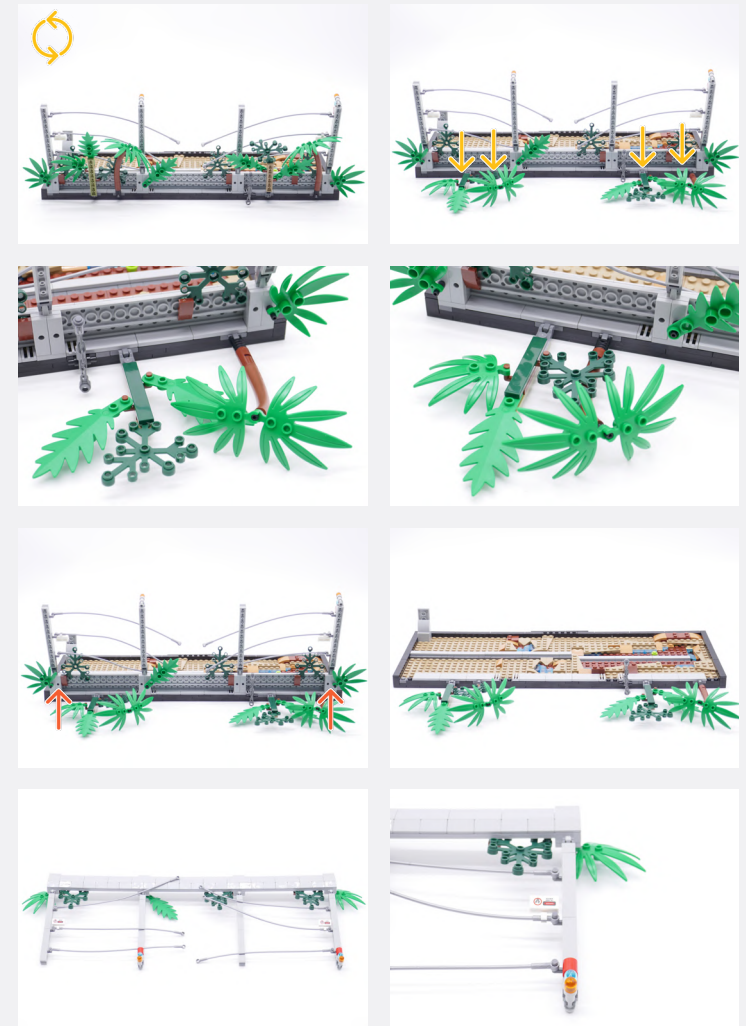
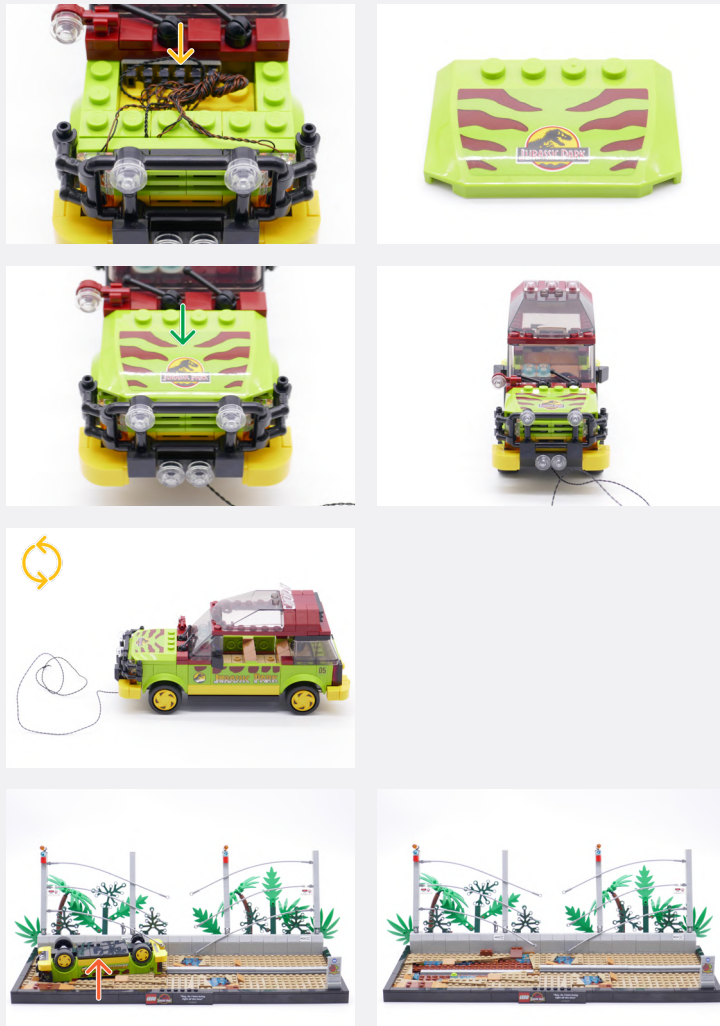

6

Legend → DISCONNECT → CONNECT / RECONNECT ↻ TURN / FLIP → DIRECTIONAL ↻ TWIST / BRAID ✨ POWER ON TEST 📝 NOTE ICON

7

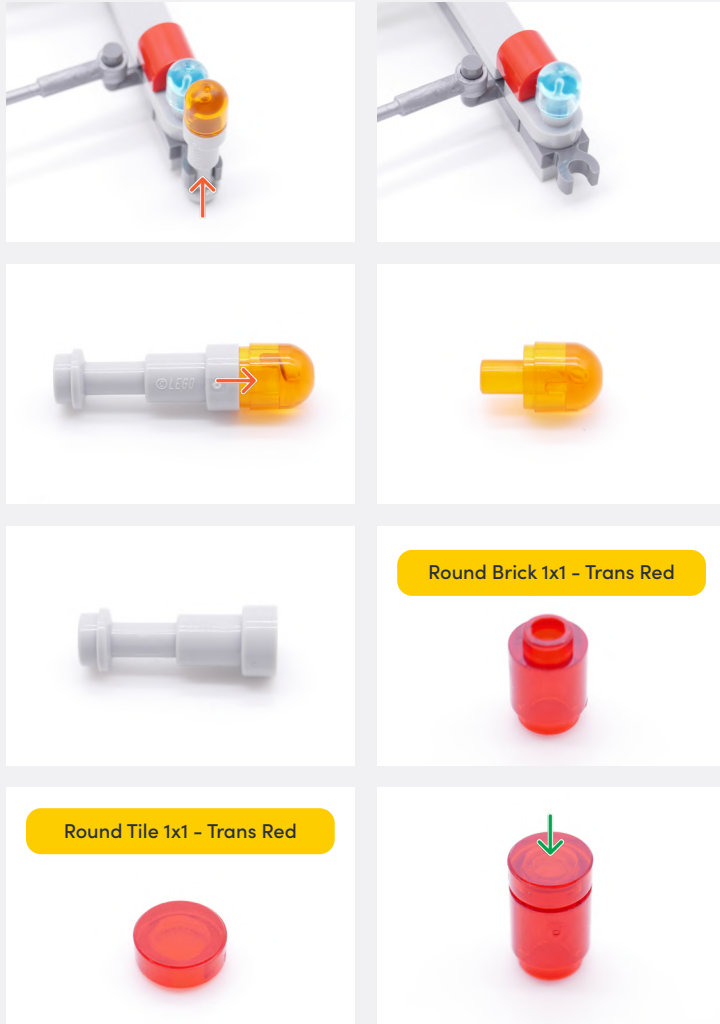

Rotating Bit Light 30cm

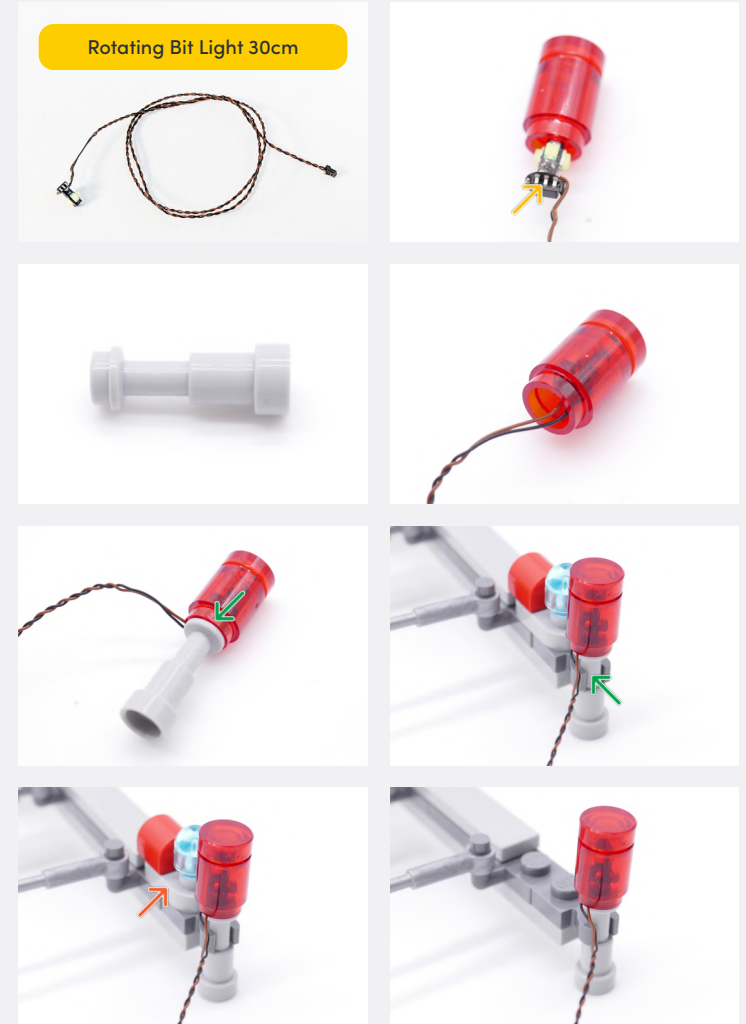

8

Legend

- DISCONNECT
- CONNECT / RECONNECT
- TURN / FLIP
- DIRECTIONAL
- TWIST / BRAID
- POWER ON TEST
- NOTE ICON

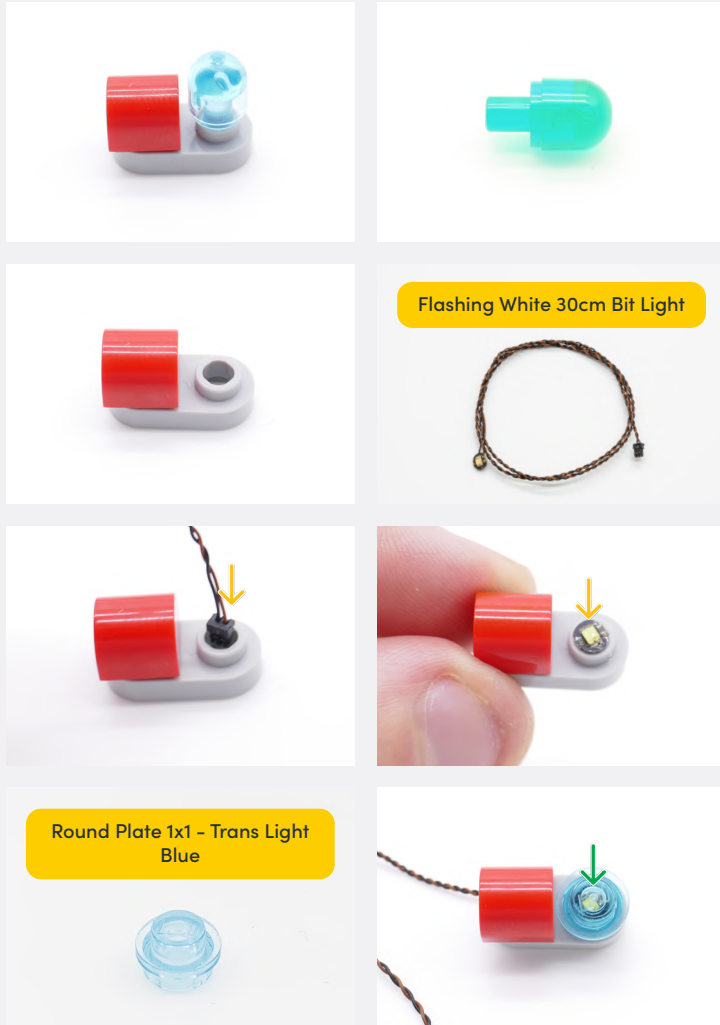

9

Repeat step 5 to left side pole.

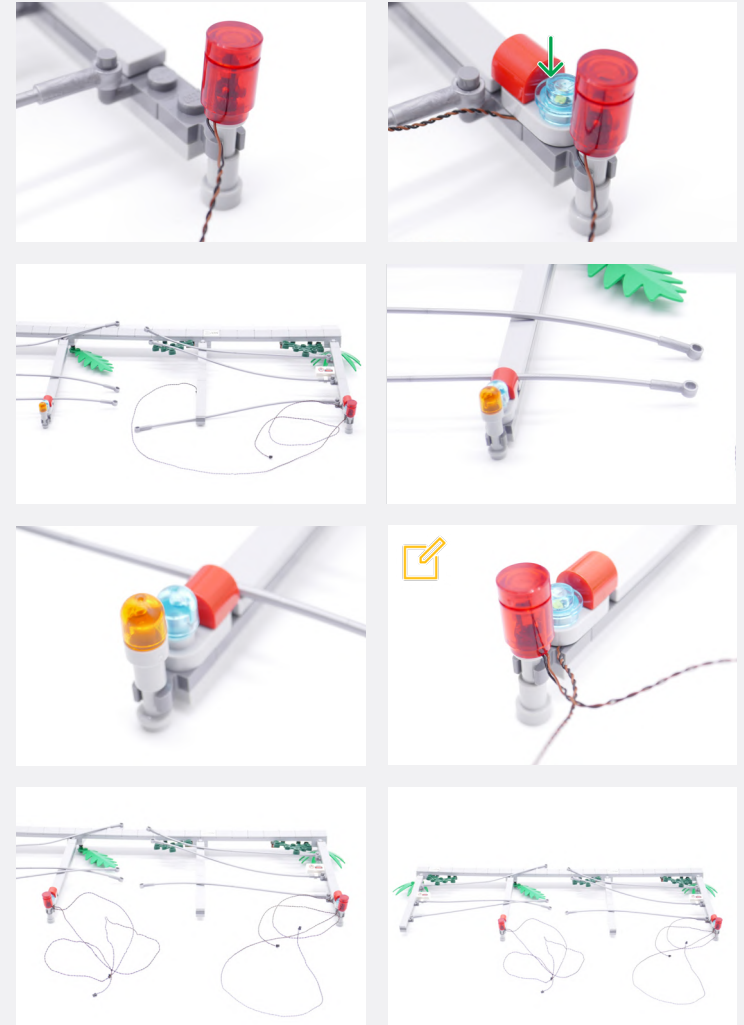

Legend

- DISCONNECT
- CONNECT / RECONNECT
- TURN / FLIP
- DIRECTIONAL
- TWIST / BRAID
- POWER ON TEST
- NOTE ICON

10

11

Legend

- DISCONNECT
- CONNECT / RECONNECT
- TURN / FLIP
- DIRECTIONAL
- TWIST / BRAID
- POWER ON TEST
- NOTE ICON



Black 1x1 Tile w/ Clip
Rounded Edges



Bracket 1x1 - Light Grey



2x2 - Dark Grey



1x2 - Light Grey

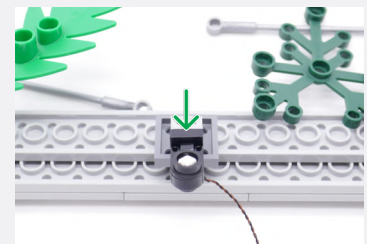
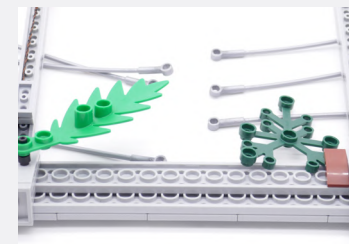
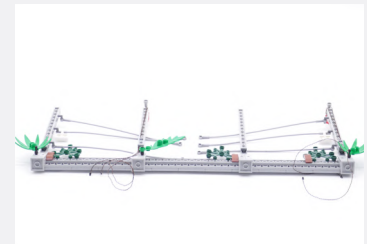
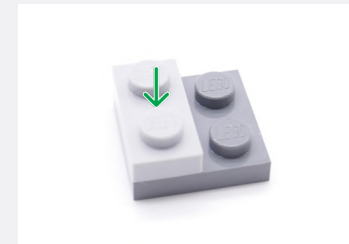

12

Connect the two lights from the left side of the fence.

6-Port Expansion Board

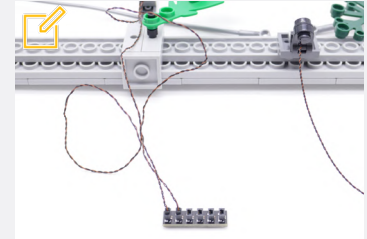

Legend DISCONNECT CONNECT / RECONNECT TURN / FLIP DIRECTIONAL TWIST / BRAID POWER ON TEST NOTE ICON

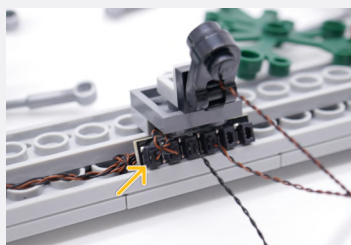
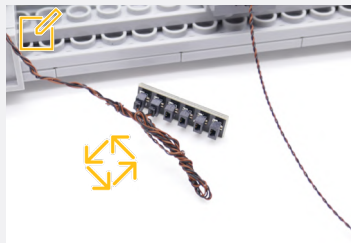
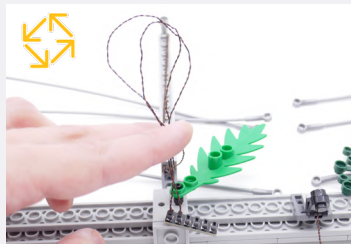
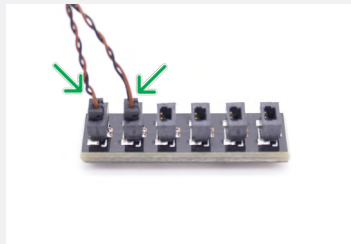

✍️ Twist the cables but ensure to leave enough slack so the 6-Port Expansion Board can reach the middle spotlight.

13

✍️ Pull USB Cable to the back.

✍️ Pull all the unconnected cables minus the USB Power Cable towards the front of the set before reconnecting the fence .

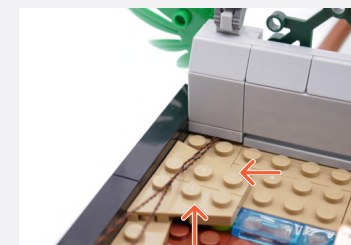
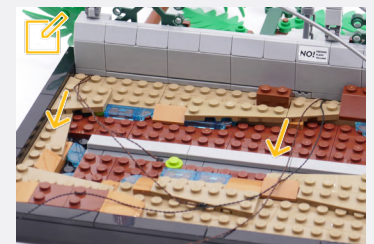
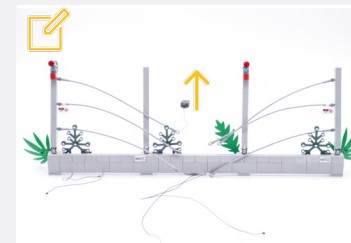
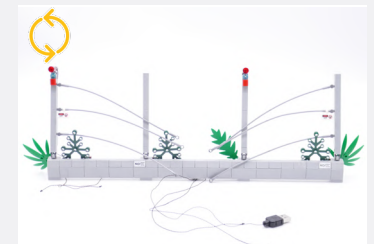
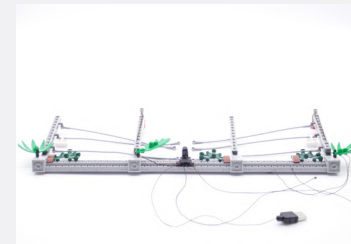

Legend → DISCONNECT → CONNECT / RECONNECT ↻ TURN / FLIP → DIRECTIONAL ↻ TWIST / BRAID ✨ POWER ON TEST ✍️ NOTE ICON

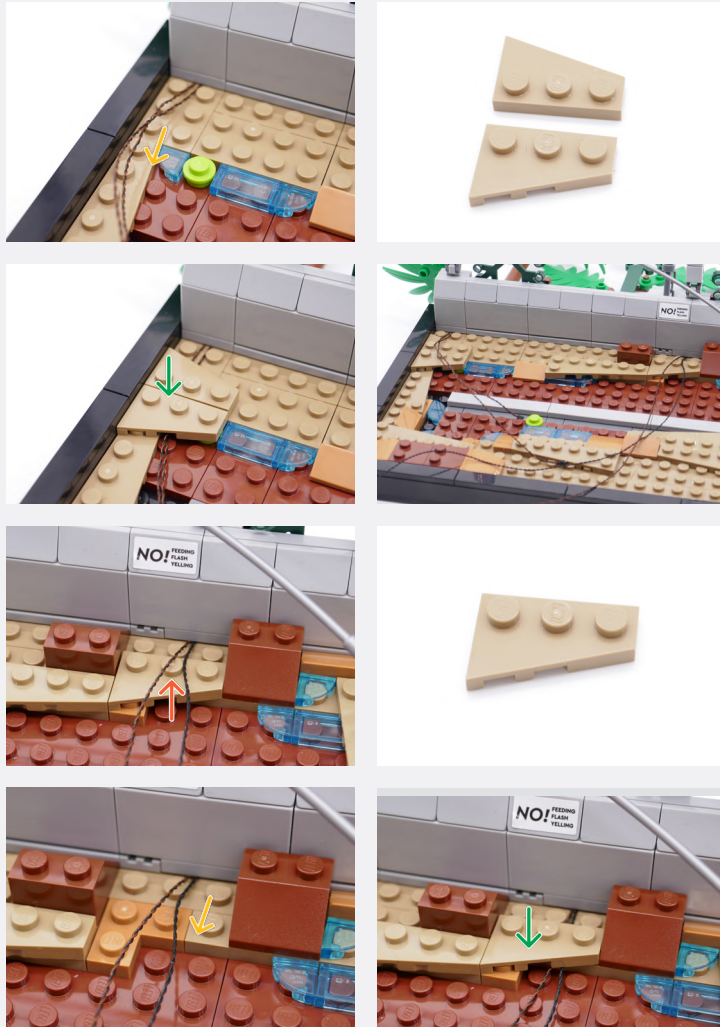

14



Black Round Plate 1x1 w/ Open Stud



White 30cm Bit Light

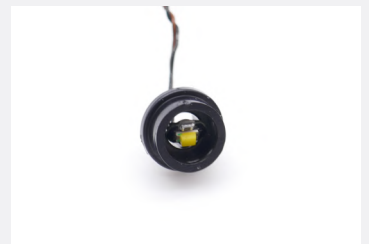

Black Round Plate 1x1 w/ Open Stud



Legend → DISCONNECT → CONNECT / RECONNECT ↻ TURN / FLIP → DIRECTIONAL ↻ TWIST / BRAID ✨ POWER ON TEST 📄 NOTE ICON

Black 1x1 Plate Modified Plate
Rounded w/ Handle



Black 1x1 Tile w/ Clip
Rounded Edges

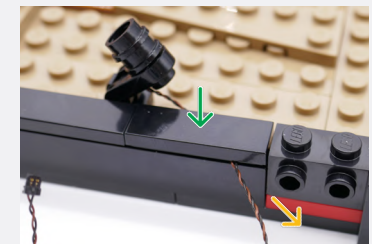
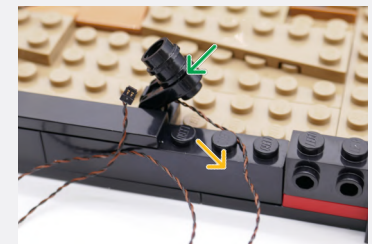

15

Legend



CONNECT / RECONNECT



TURN / FLIP



DIRECTIONAL



TWIST / BRAID





POWER ON TEST

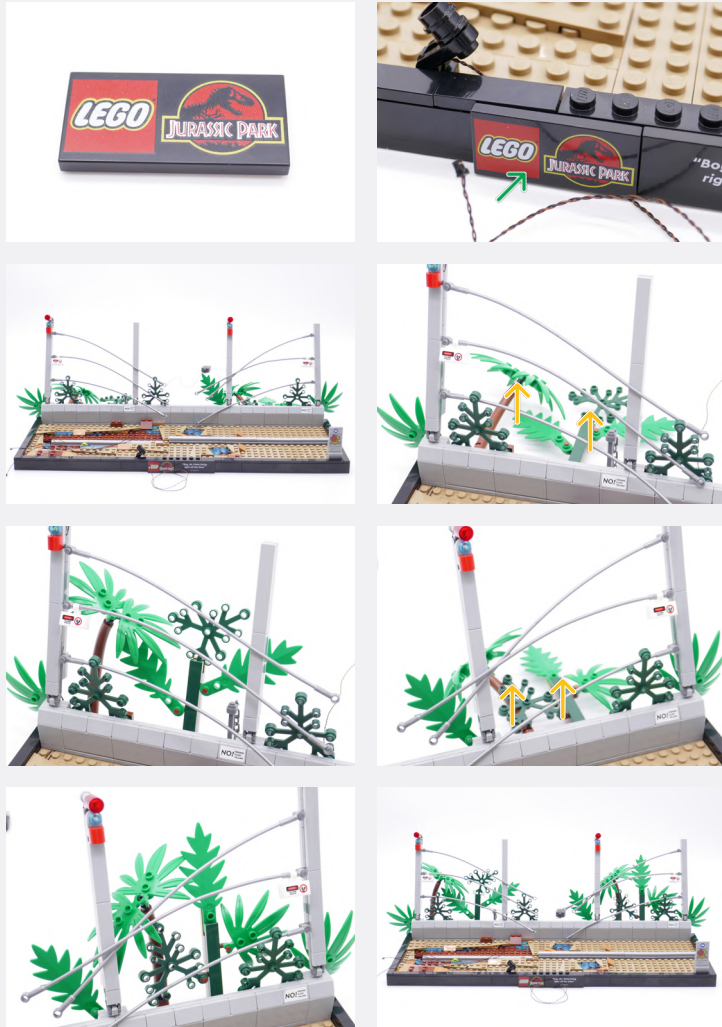

NOTE ICON

16



 Pull Bit Light Cable from front of kit, underneath model to the back.

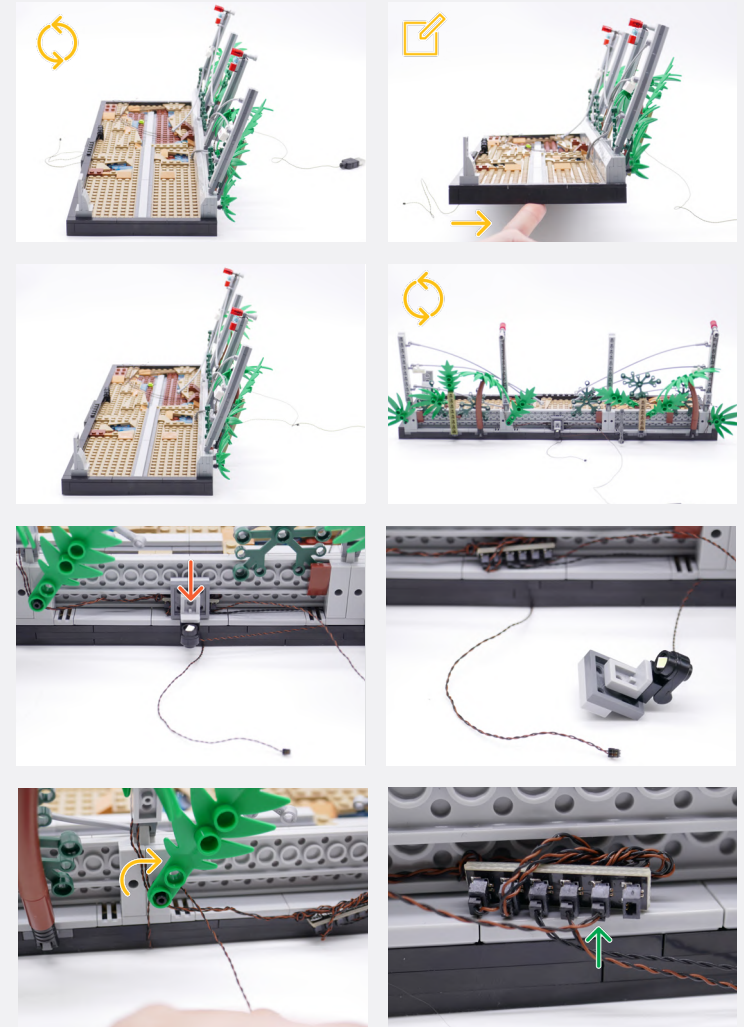

Legend  DISCONNECT  CONNECT / RECONNECT  TURN / FLIP  DIRECTIONAL  TWIST / BRAID  POWER ON TEST  NOTE ICON

17

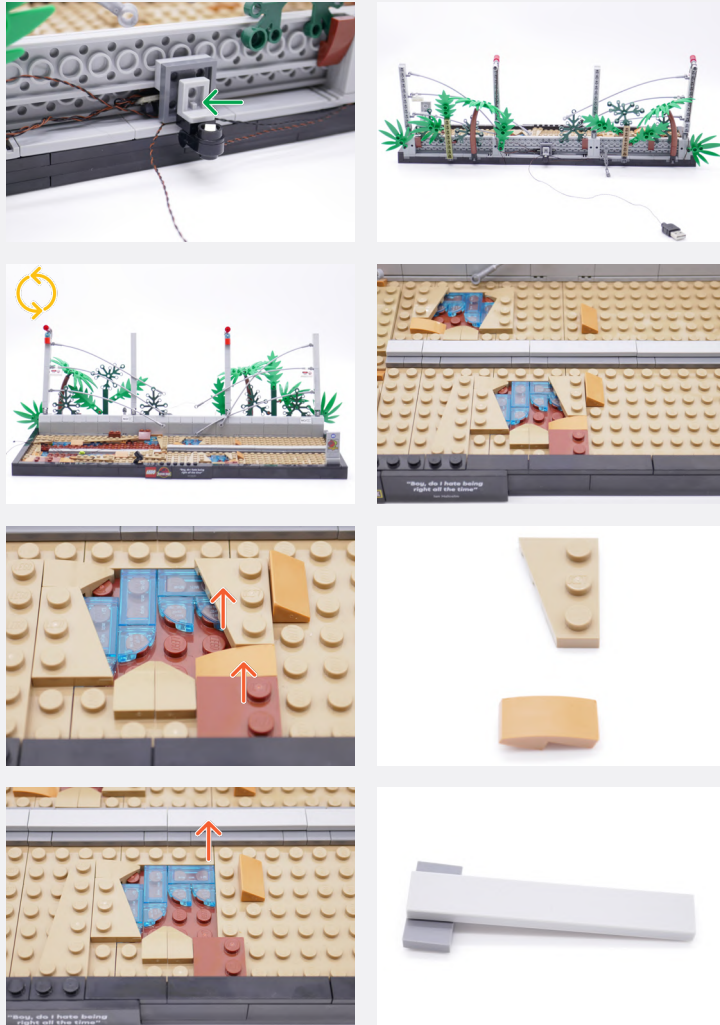

18

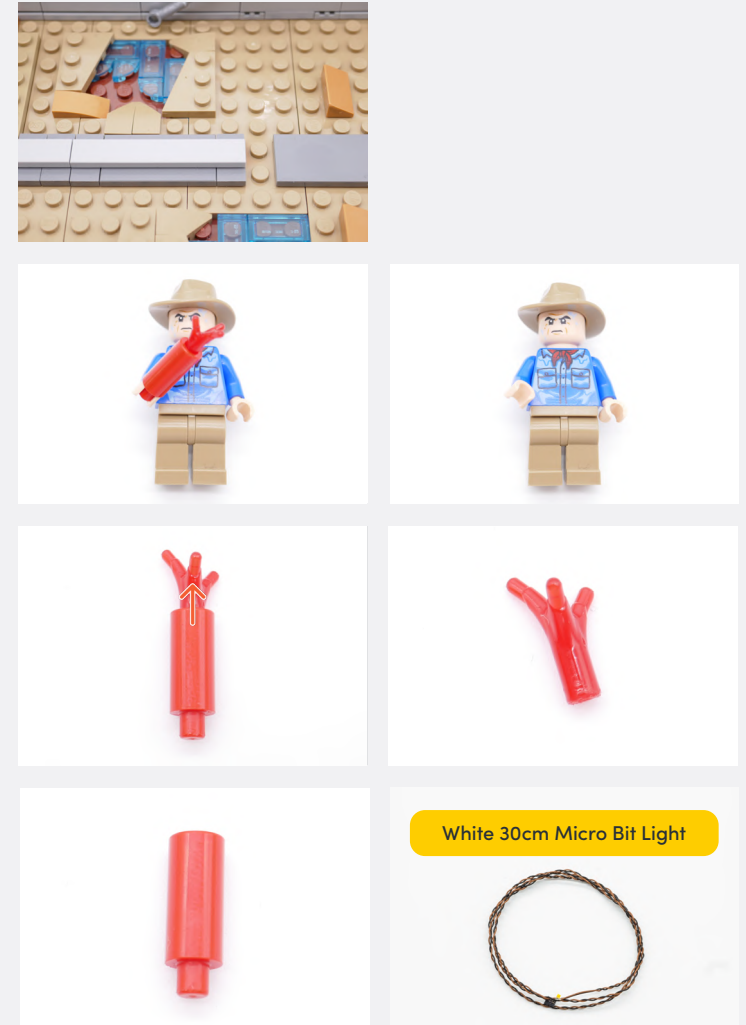

Legend

- DISCONNECT
- CONNECT / RECONNECT
- TURN / FLIP
- DIRECTIONAL
- TWIST / BRAID
- POWER ON TEST
- NOTE ICON

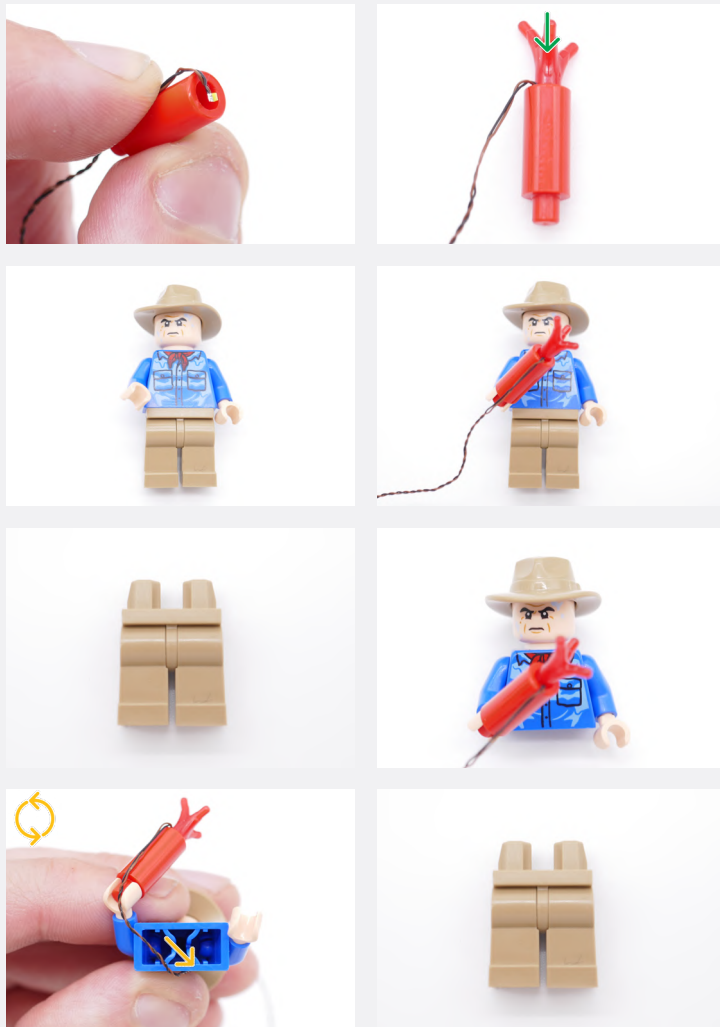

19

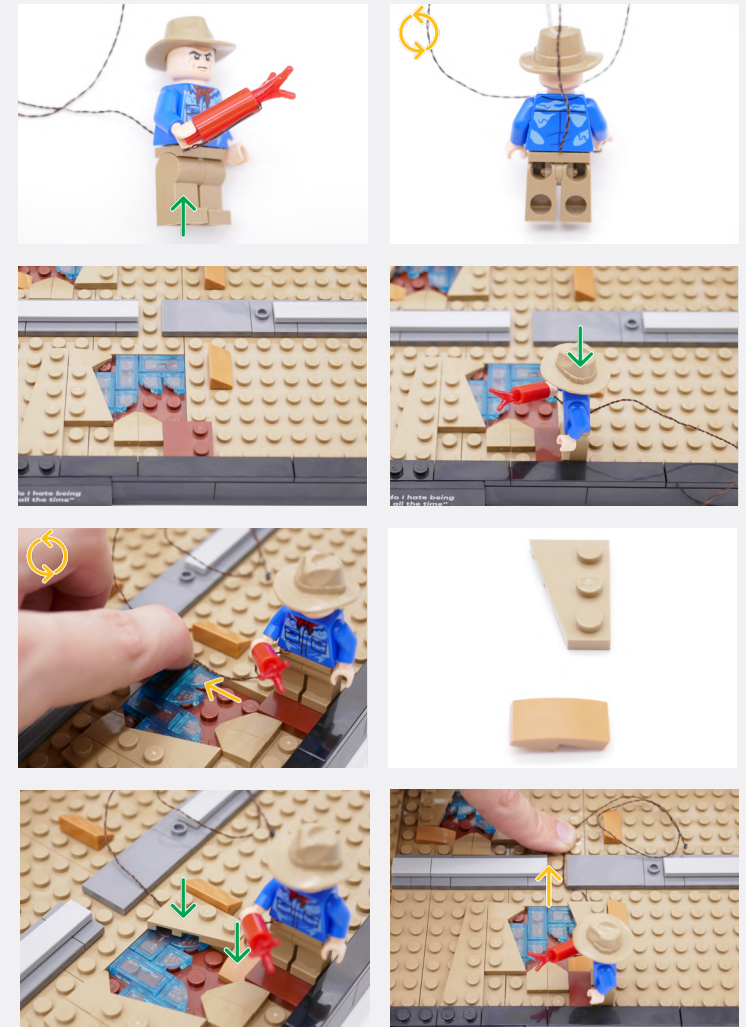

Legend → DISCONNECT → CONNECT / RECONNECT ↻ TURN / FLIP → DIRECTIONAL ↻ TWIST / BRAID * POWER ON TEST 📝 NOTE ICON

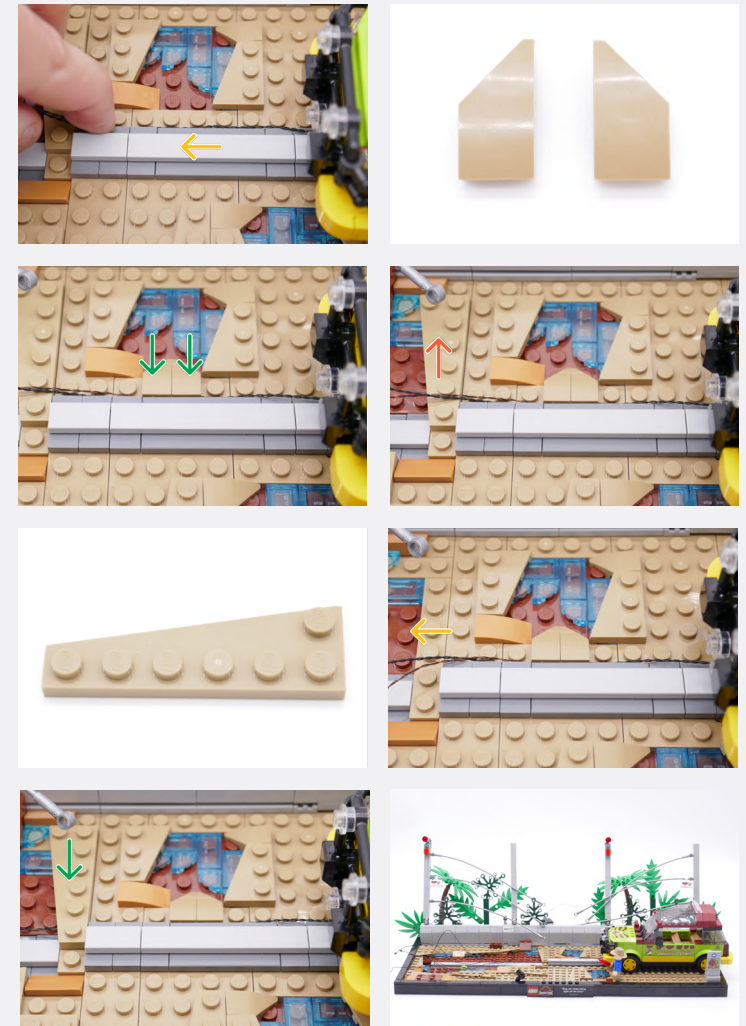
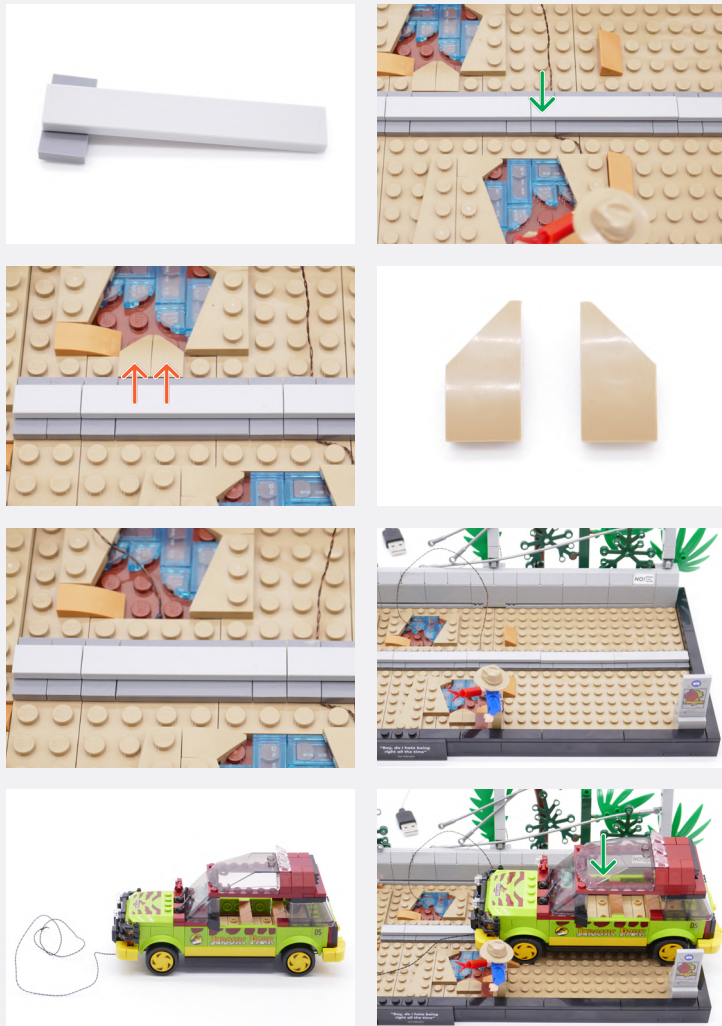

20

Legend → DISCONNECT → CONNECT / RECONNECT ↻ TURN / FLIP → DIRECTIONAL ↺ TWIST / BRAID * POWER ON TEST 📝 NOTE ICON

21

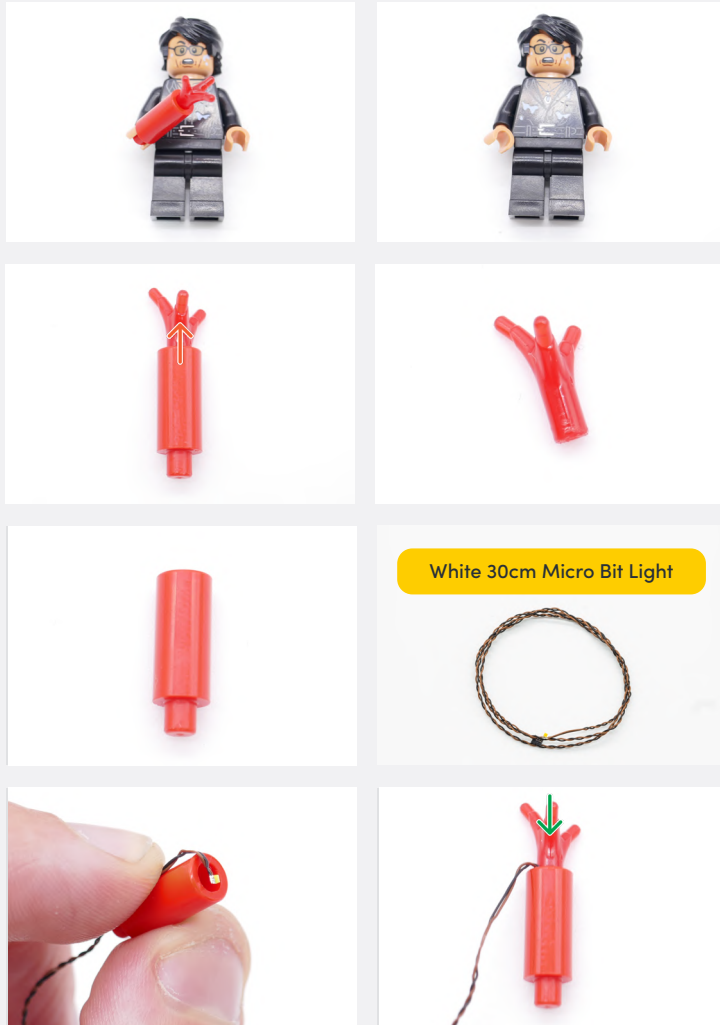

22



Legend

- DISCONNECT
- CONNECT / RECONNECT
- TURN / FLIP
- DIRECTIONAL
- TWIST / BRAID
- POWER ON TEST
- NOTE ICON

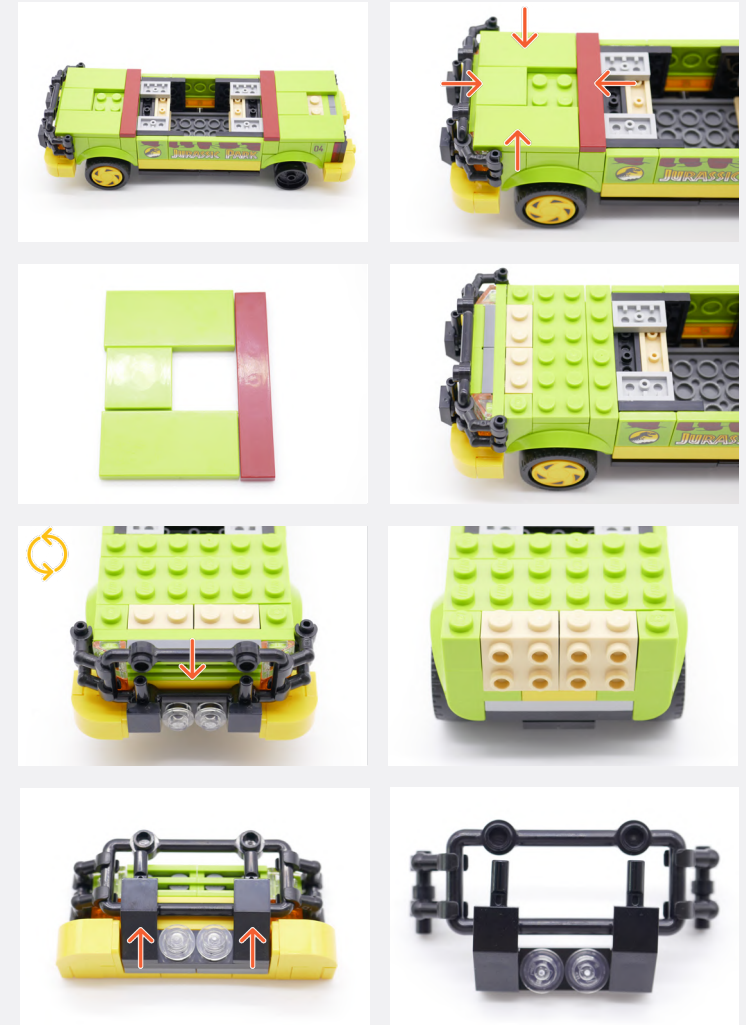
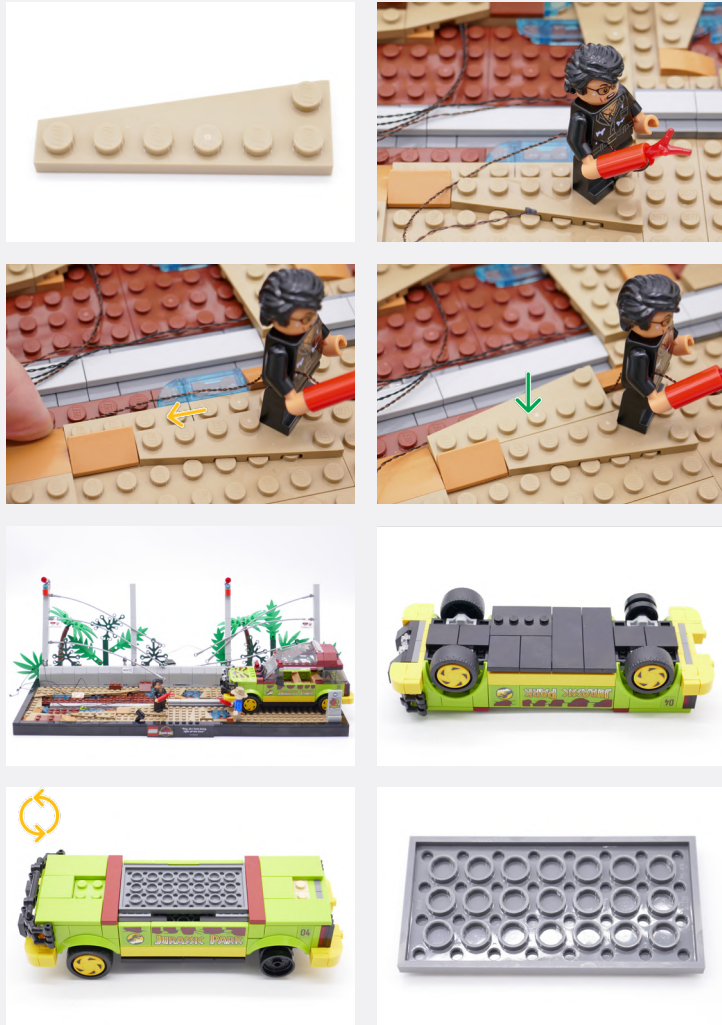

23

Legend

-  DISCONNECT
-  CONNECT / RECONNECT
-  TURN / FLIP
-  DIRECTIONAL
-  TWIST / BRAID
-  POWER ON TEST
-  NOTE ICON

24

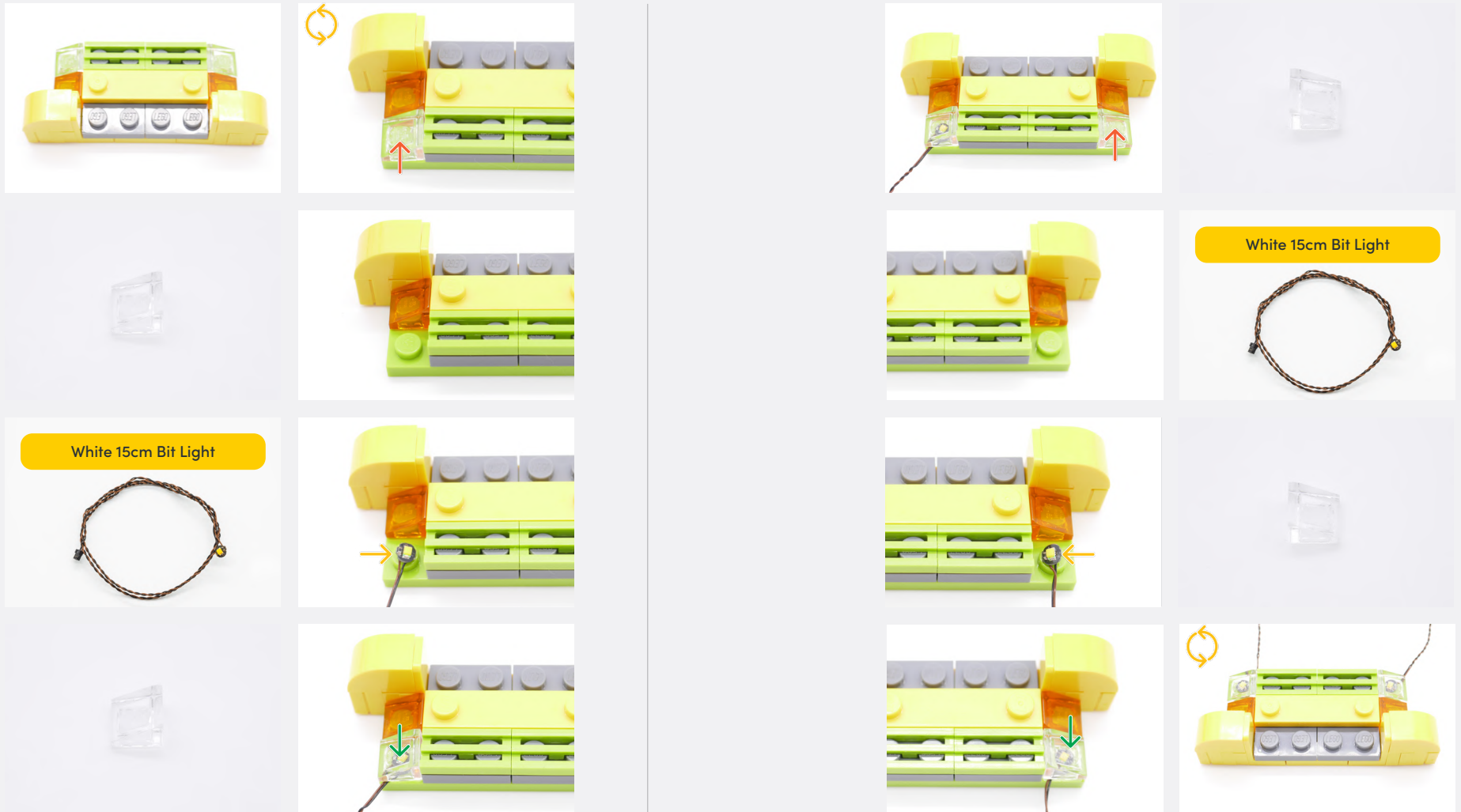

Legend

- DISCONNECT
- CONNECT / RECONNECT
- TURN / FLIP
- DIRECTIONAL
- TWIST / BRAID
- POWER ON TEST
- NOTE ICON

25



26



Legend

- DISCONNECT
- CONNECT / RECONNECT
- ↻ TURN / FLIP
- DIRECTIONAL
- ↻↻ TWIST / BRAID
- ✳ POWER ON TEST
- 📝 NOTE ICON

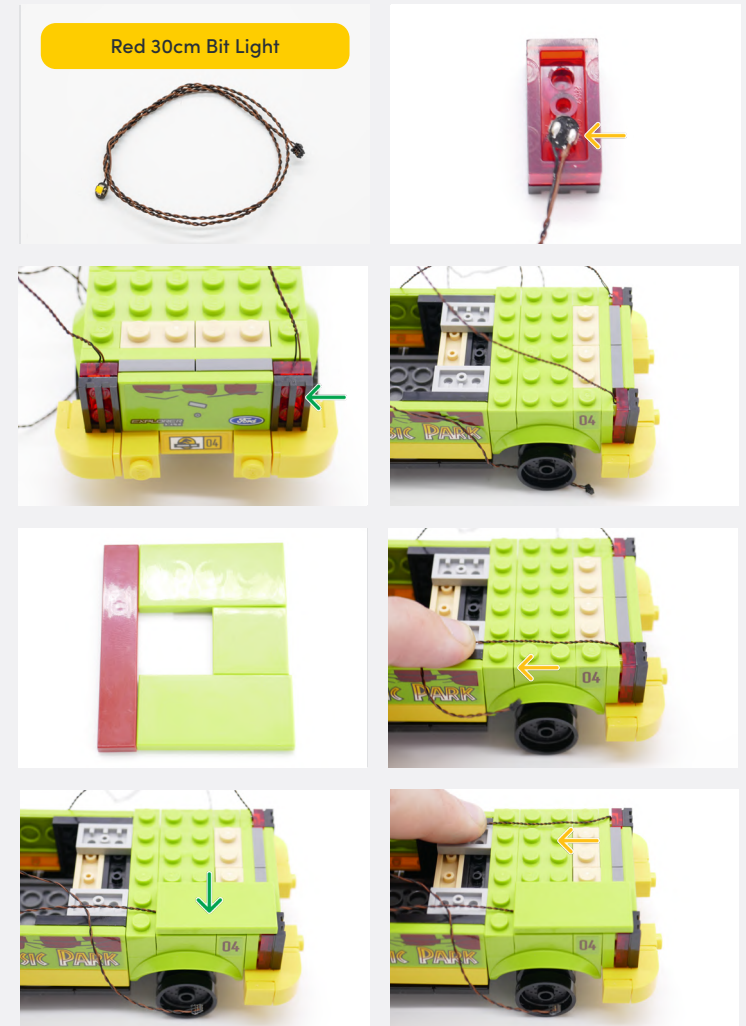
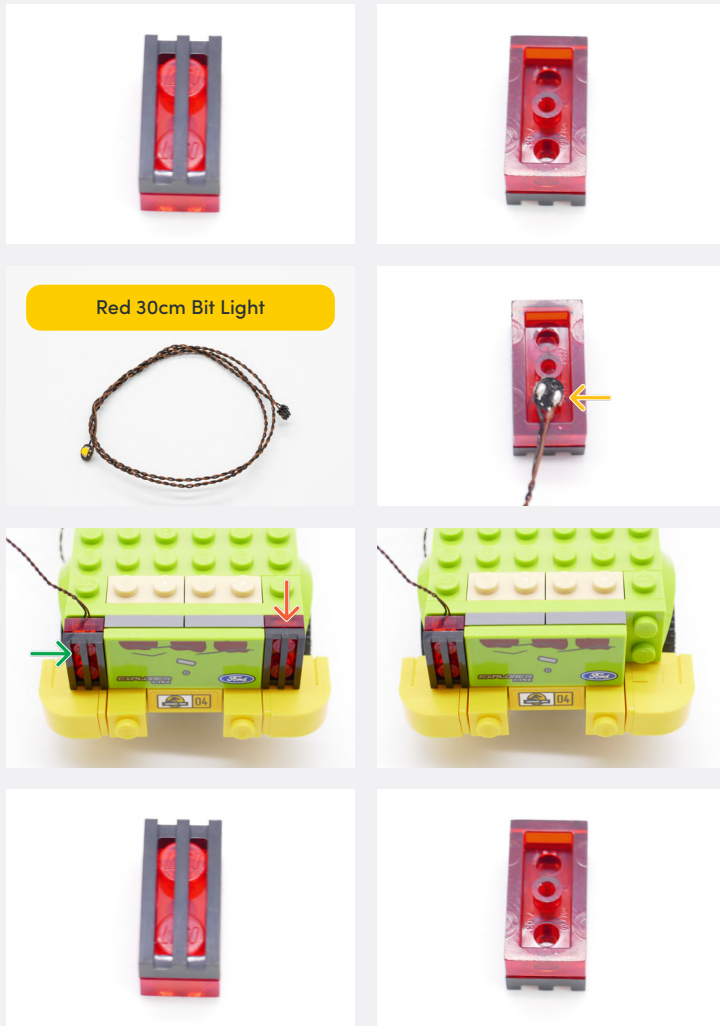

27

Legend → DISCONNECT → CONNECT / RECONNECT ↻ TURN / FLIP → DIRECTIONAL ↻ TWIST / BRAID * POWER ON TEST 📝 NOTE ICON

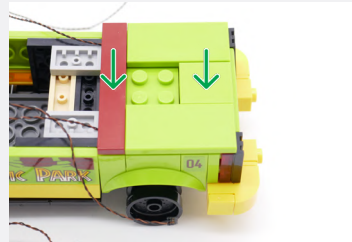
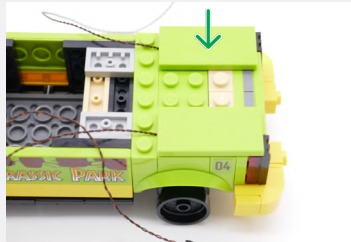
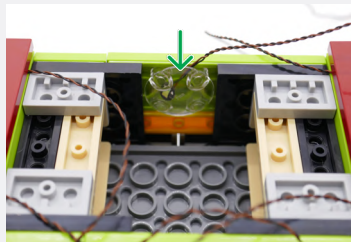
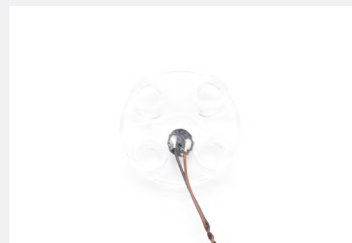

Plate 2x2 W Rounded Bottom - Trans Clear



Cool White 15cm Bit Light



28

Scary Effects Board: Code SFXV1 on the back.



Connect the headlights to the 'OUT' port of the Scary Effects Board.

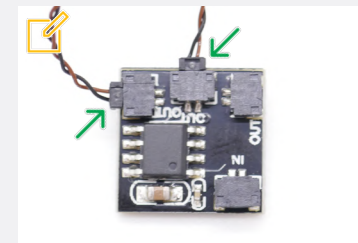

Flicker Effects Board: Code FFXV4 on the back.

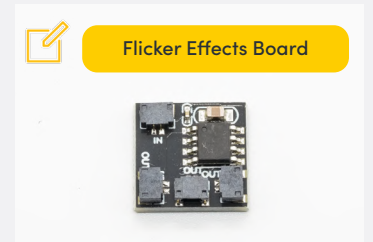
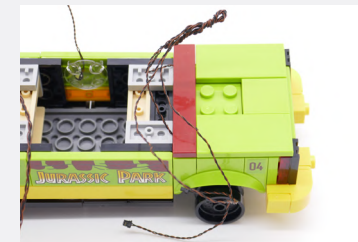

Legend

- DISCONNECT
- CONNECT / RECONNECT
- TURN / FLIP
- DIRECTIONAL
- TWIST / BRAID
- POWER ON TEST
- NOTE ICON

One tail light connects to last port in Scary Effects Board. The other connects to First outlet in Flicker Effects Board.

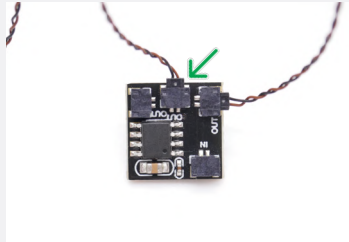
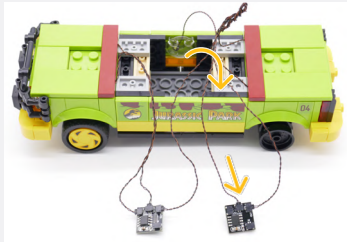
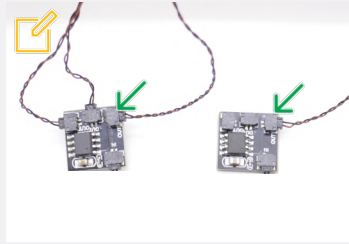
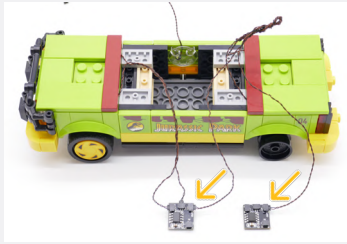

5cm Connecting Cable



x2

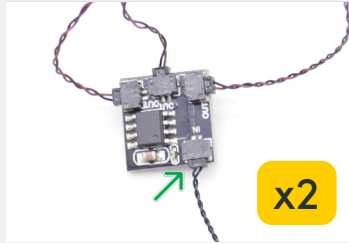

x2

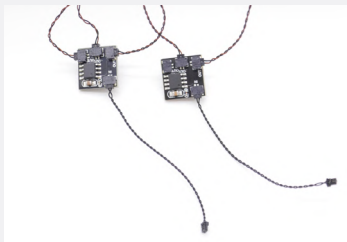

4-Port Micro Expansion Board



5cm Connecting Cable

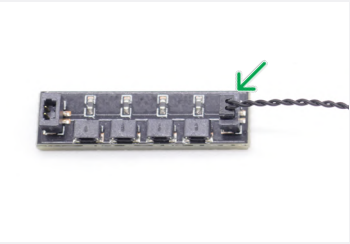

Connect the 5cm Connecting Cable from the Micro Expansion Board to the last port of the Flicker Effects Board.

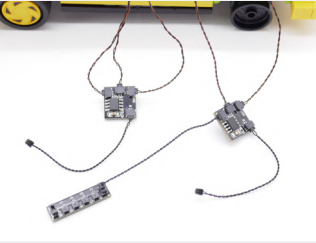
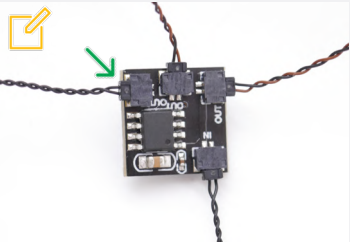
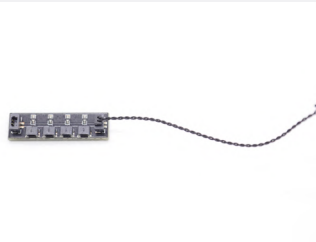

8-Port Expansion Board

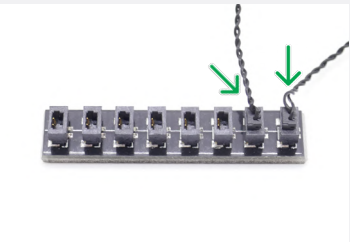
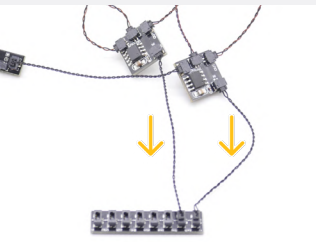

Legend → DISCONNECT → CONNECT / RECONNECT ↻ TURN / FLIP → DIRECTIONAL ↻ TWIST / BRAID * POWER ON TEST 📝 NOTE ICON

30

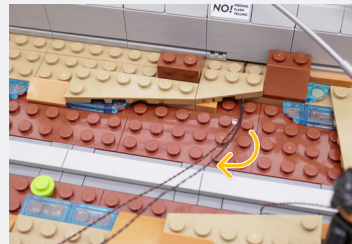

Connect the two lights from the electric fence to the 8-Port Expansion Board.

Connect the Connecting Cable from behind to the 8-Port Expansion Board.
Connect the Bit Light from behind to the 4-port Micro Expansion Board.

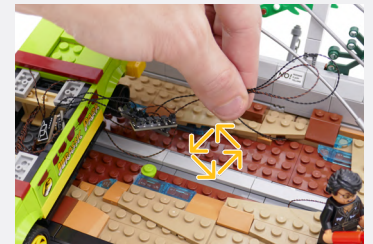
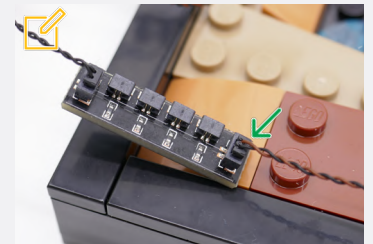
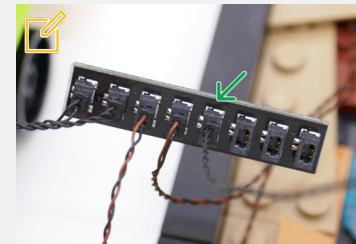

Take a hold of the remaining three cables from behind mini figure.



Connect the Connecting Cable to the 8-port Expansion Board. Connect the two Micro Bit Lights to the 4-port Micro Expansion Board.

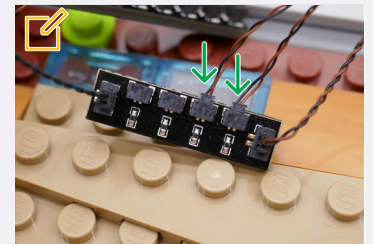
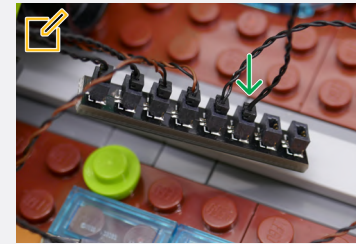

Legend → DISCONNECT → CONNECT / RECONNECT ↻ TURN / FLIP → DIRECTIONAL ↻ TWIST / BRAID ✨ POWER ON TEST 📌 NOTE ICON

31



32

⚡ Connect the other end to a 5V USB Power Bank, 5V USB Wall Adaptor, or USB to AA Battery Pack (sold separately)

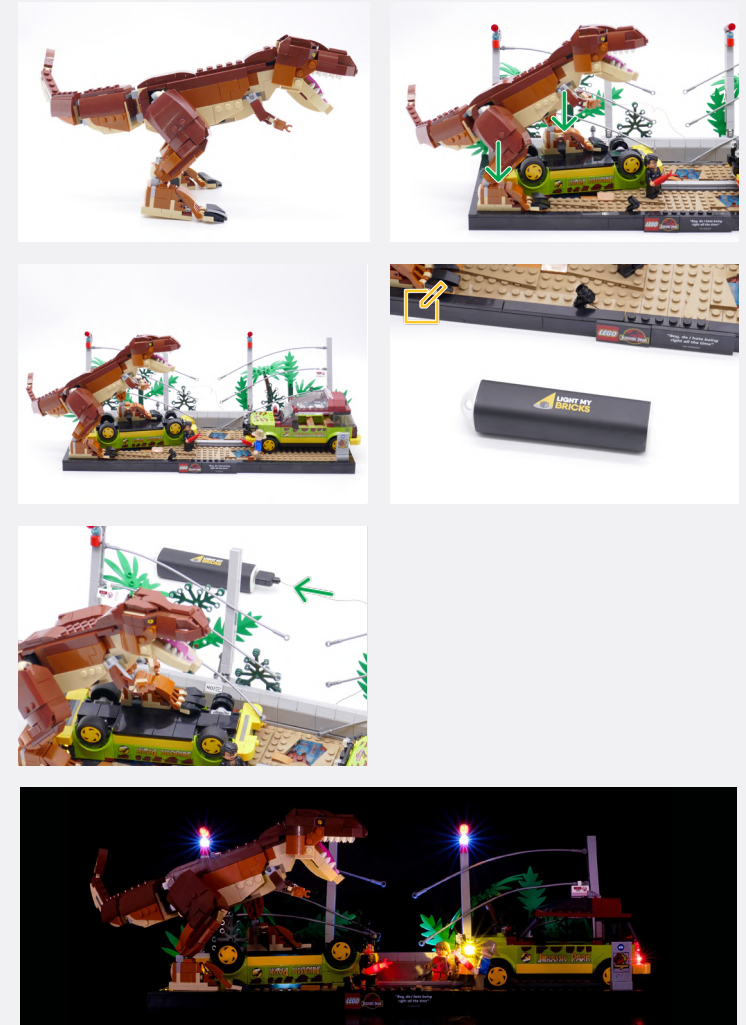

Legend

- DISCONNECT
- CONNECT / RECONNECT
- ↻ TURN / FLIP
- DIRECTIONAL
- ↻ TWIST / BRAID
- ⚡ POWER ON TEST
- 📌 NOTE ICON

FINAL PRODUCT

This finally completes installation of the Light My Bricks
LEGO T.Rex Breakout 76956 Light Kit.

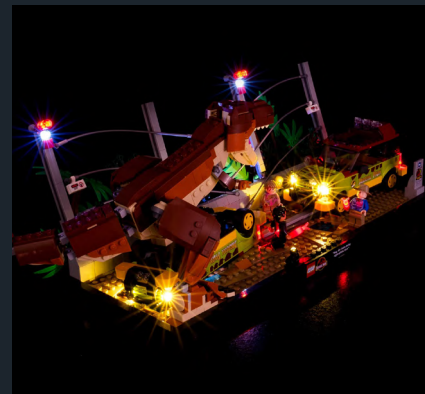



TROUBLESHOOTING

Light My Bricks lighting kits contain individual components that are very small and can be easily damaged if not handled correctly.

To prevent unnecessary damage to components, we highly recommend that the User Guide section, **“Important things to note”** is read carefully. Follow the handling procedures in the User Guide to help prevent faults and damages to your Light My Bricks components.

If you are experiencing issues with your Light My Bricks set, watch our troubleshooting video or read on for a list of common causes to help you troubleshoot.

Troubleshooting

Firstly, ensure that the batteries have power using a battery charge gauge.

If the batteries have no power, replace the batteries.

If the batteries still have power, check to see if the batteries have been inserted correctly into the battery pack.

Check For CR2032 Batteries Using The Flat Battery Pack

Inside the battery pack is a symbol indicating which side the (round) CR2032 battery should be inserted. Check that the “+” side of the battery pack has the battery with the “+” symbol facing downwards.

On the opposite side, the “-” side of the battery pack should have the battery flipped upside down, that is the “+” symbol facing upwards.

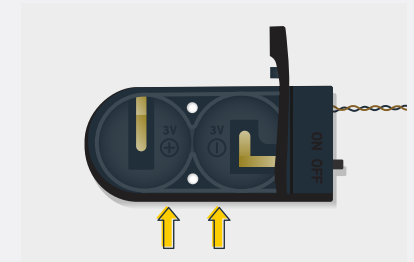

Troubleshooting

Check For Cr2032 Batteries Using The Round Battery Pack

Inside the battery pack is a symbol indicating which side the (round) CR2032 battery should be inserted. In this case, for the stacked battery pack, ensure that BOTH batteries have the “+” symbol facing upwards.

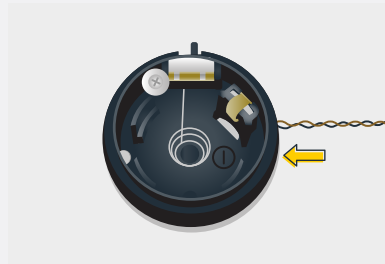

Check for AA batteries using the AA battery pack

Inside the battery pack are symbols indicating which direction the AA battery should be inserted. The flat side of the battery should be paired with the spring side of the battery pack.

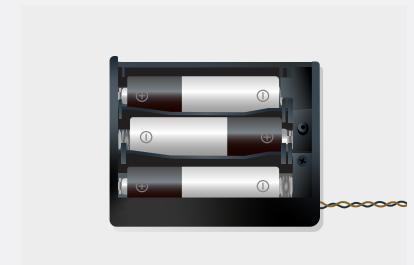
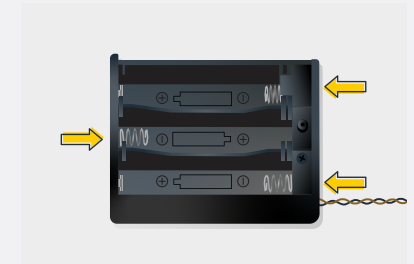

Troubleshooting

Check Your Wires

In order for Light My Bricks components to fit in between and underneath LEGO® bricks, the components need to be very small. Due to this nature, Light My Bricks components can be easily damaged when not handled correctly.

Be careful when removing unpacked components out of the packaging and ensure not to forcibly pull at the wires as this can damage the soldering that attach the wires to the LEDs.

If the wiring is detached from the LED itself, the light will not operate.

When connecting lights to your LEGO set, check that there are no pinched wires underneath or in between bricks and plates. When the wires are pinched and the exposed wires are touching each other, this can cause a crosswire and the lights to not function correctly.

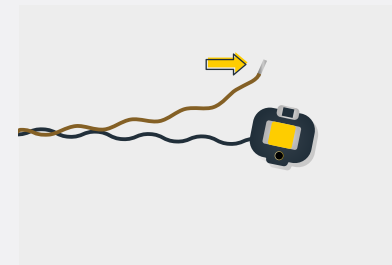
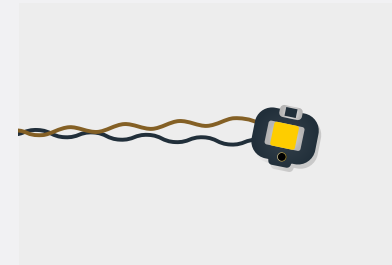

Troubleshooting

Check Your Expansion Board Ports/ Strip Light Ports / Effects Board Ports

It is important to note that connectors can only be inserted to the expansion board, strip light, or effects board ports in one direction.

Forcibly inserting connectors in the incorrect direction will result in damaging the pins inside each of the ports on your component board.

Not only will a light connected to the damaged port not work, but if the pins inside the port are bent to a point they are touching each other, this can result in all other lights in the system to stop working. This is a short circuit.

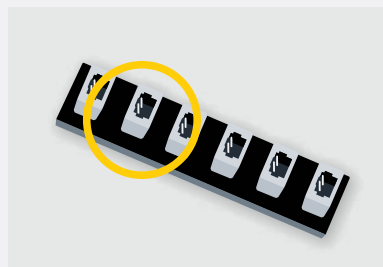
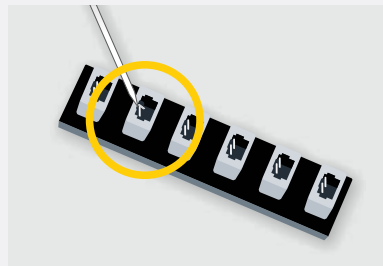

A short circuit can also result in overheating of the board, cable or batteries. If you suspect a short circuit, **DISCONNECT POWER IMMEDIATELY**. Batteries can fail, catch fire, or even explode if left connected to a short circuit for too long.

If you suspect you have a faulty component due to a bent pin, try the following steps:

If you look carefully inside each of the ports, each port contains 2 small pins that should be straight. You will be able to identify a faulty port if it has any bent pins.

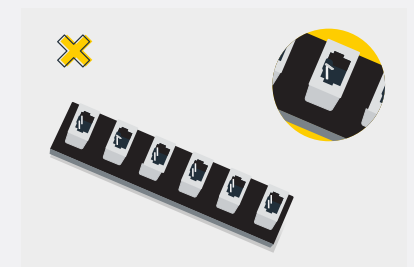
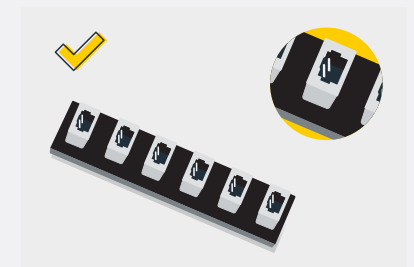
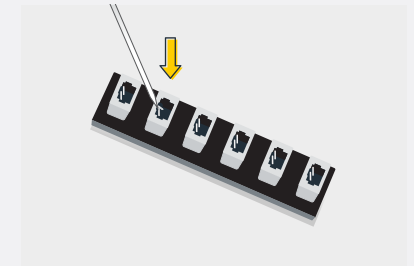



CONTACT US

If you have an enquiry regarding the online shop, our products or a general enquiry please refer to our Frequently Asked Questions webpage.

Alternatively, you can contact our Customer Services team by visiting our online support portal.

support.lightmybricks.com

We thank you for purchasing this product and hope you enjoy!



lightmybricks.com